

Note- Plans to be read in conjunction with engineers details

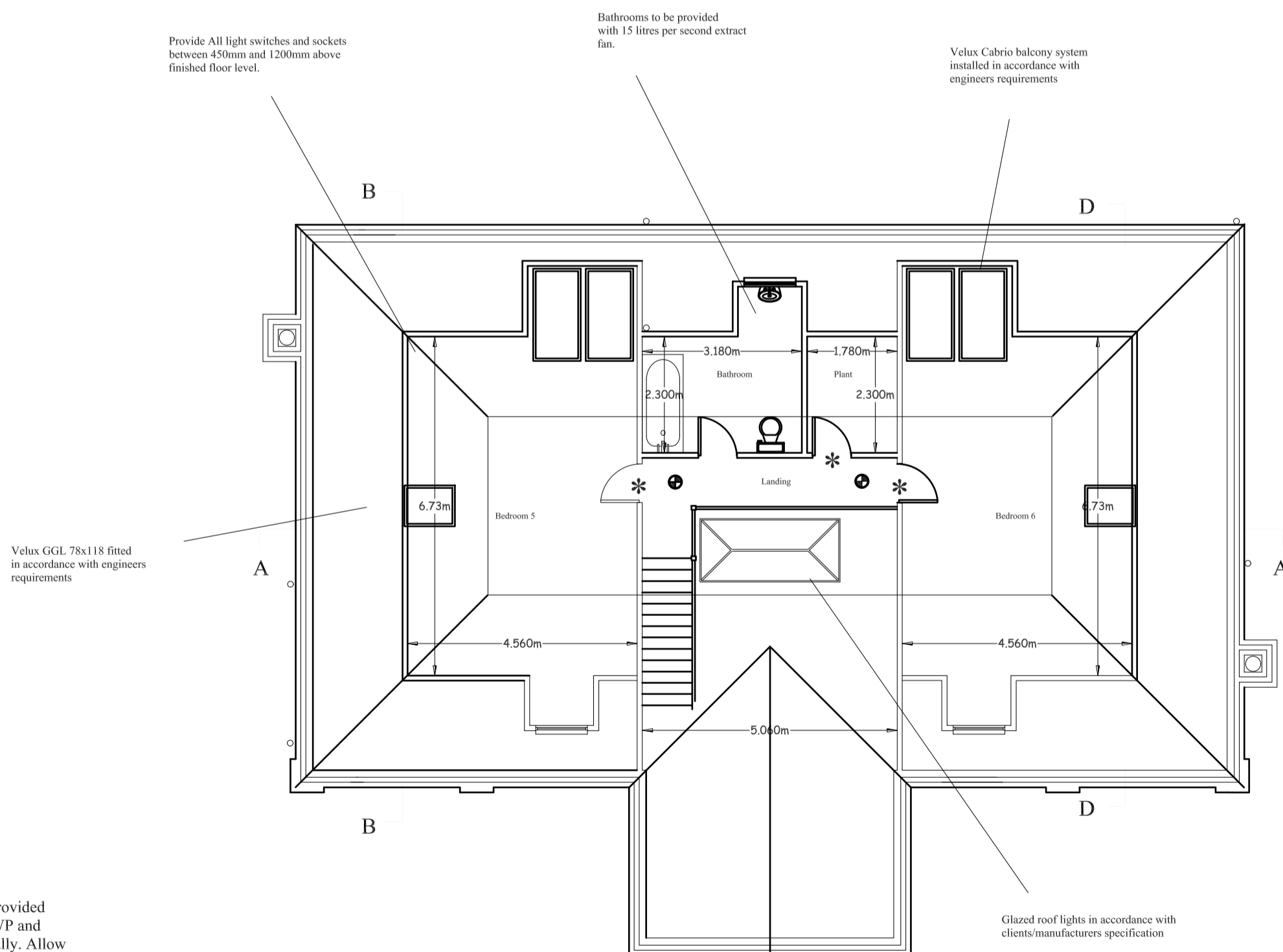
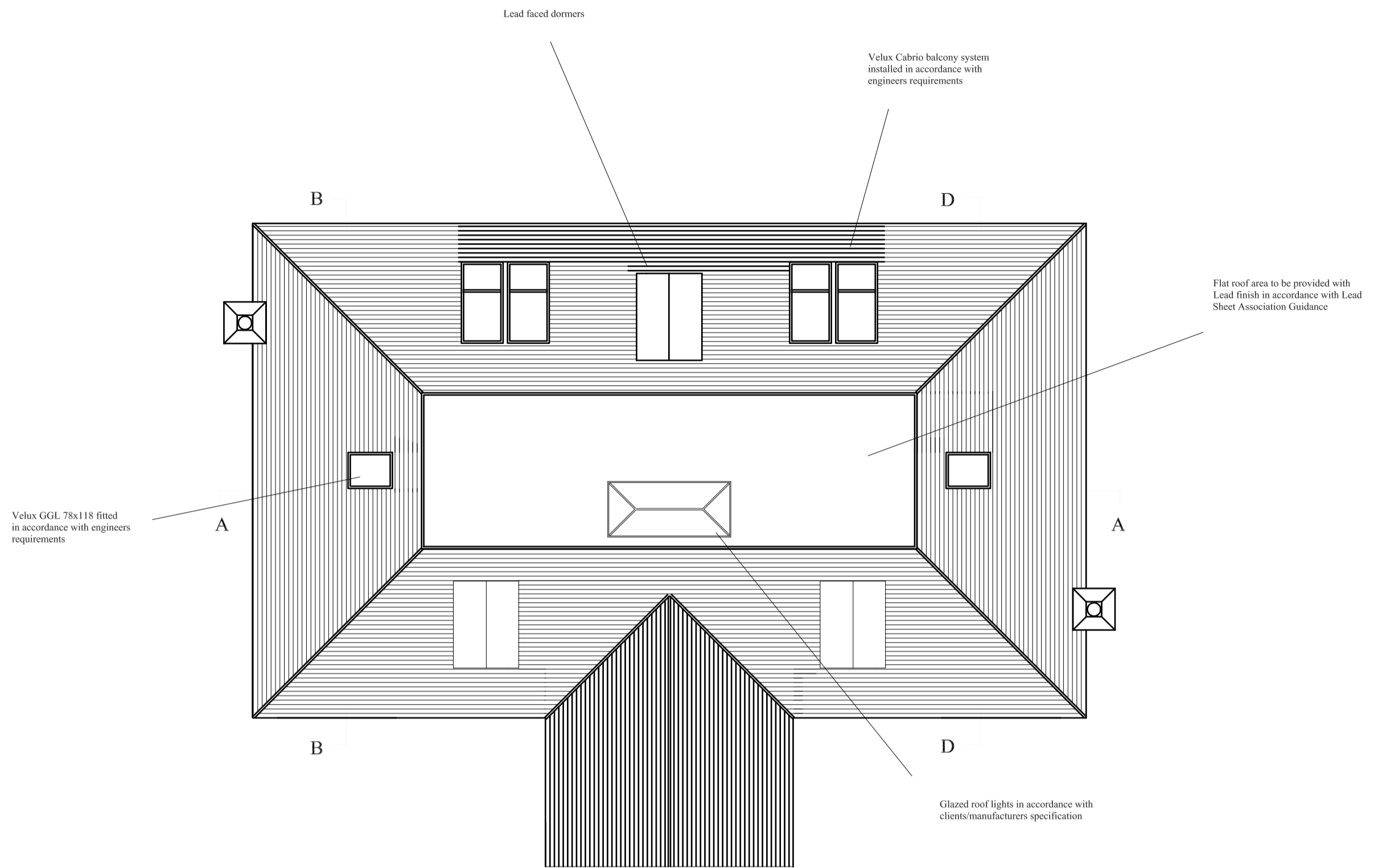

Note- Allow for plinth to be provided with stop ends to allow for RWP and external pipes to be run vertically. Allow for face brickwork to be run behind stop ends. Alternatively provide bottom of all pipework with dog legs with rodding access.

Note- All ground floor blockwork to cavity walls and internal walls to be in 7n/mm blockwork. First Floor to be 4n/mm

Note-Dimensions of returns to walls adjacent to openings to be adjusted where required to suit brick coursing

Proposed lighting to be in accordance with Part L1 of the Approved Documents. 1 in 4 light fittings shall be provided with light fittings having a luminous efficacy greater than 40 lumens watt per circuit. External lighting to have PIR and light level indicators.

* FD20 fire doors
 ⊕ Mains wired interlinked smoke alarms

Client	Mr and Mrs Greenaway	Drawing Title	Proposed Second Floor
Job Title	Replacement Dwelling at Greensleeves, The Glade Kingswood,	Scale	1:100
		Date	July 2010
		Drawing No	08/31-04K
		Drawn By	KRS Designs