

All dimensions to be checked on site prior to the commencement of construction. All dimensions are to structure and any discrepancy should be reported to the architect immediately. This drawing may NOT be reproduced in any part or form without written permission from Fulcrum Design Ltd. Subcontractor MUST ensure that they have the latest issued drawing before they commence work on site.

KEY

- SVP Soil & vent pipe 110mm dia
- RWP Rain water downpipe
- BIG Back inlet gully
- SSA Silt stack fitted with air admittance valve
- DDC Direct drain connection
- MVJ Movement joint
- OTG Outside tap with back inlet gully
- OUT Outside tap
- CCR Proprietary insulated cavity closer to all external reveals
- CWB Carry bar
- LBW Lath and render wall
- BSB Boiler fixed with foot rest
- BSP Boiler fixed with foot rest
- AGV Automatic opening ventilator
- PAO Radiator
- BFT Boiler flue terminal
- HTR Heated towel rail
- OGW Obscure glazed window
- IH Insulated lift hatch

Mechanical Extraction

- MEU Mechanical extract fan terminal from utility room min extract rate 30 litres / sec
- MEC Mechanical extract fan terminal from cloak's min extract rate 15 litres / sec
- MEB Mechanical extract fan terminal from bathroom min extract rate 15 litres / sec
- MEE Mechanical extract fan terminal from en-suite min extract rate 15 litres / sec
- MEH Mechanical extract fan terminal from cooker hood min extract rate 30 litres / sec

Doors

- ☐ Door leaf shown thus indicates non fire resistant door
- ◼ Door leaf shown thus indicates 30/30 fire resistant door and filled with smoke seals.
- ◼ Door leaf shown thus indicates 60/60 fire resistant door and filled with smoke seals.

Ref Door sizes

- D1 864 x 1981mm
- D2 839 x 1981mm
- D3 762 x 1981mm
- D4 666 x 1981mm
- D5 610 x 1981mm
- D6 539 x 1981mm
- D7 457 x 1981mm
- D8 Pair of 638 x 1981mm
- D9 Pair of 762 x 1981mm
- D10 Pair of 688 x 1981mm
- D11 Pair of 610 x 1981mm
- D12 Pair of 532 x 1981mm
- D13 Pair of 493 x 1981mm

Block / Blockwork Hatching

- ▨ Facing blockwork
- ▨ 3.5kN/m Lightweight concrete blockwork
- ▨ 2kN/m Lightweight concrete blockwork
- ▨ 10kN/m Lightweight concrete blockwork

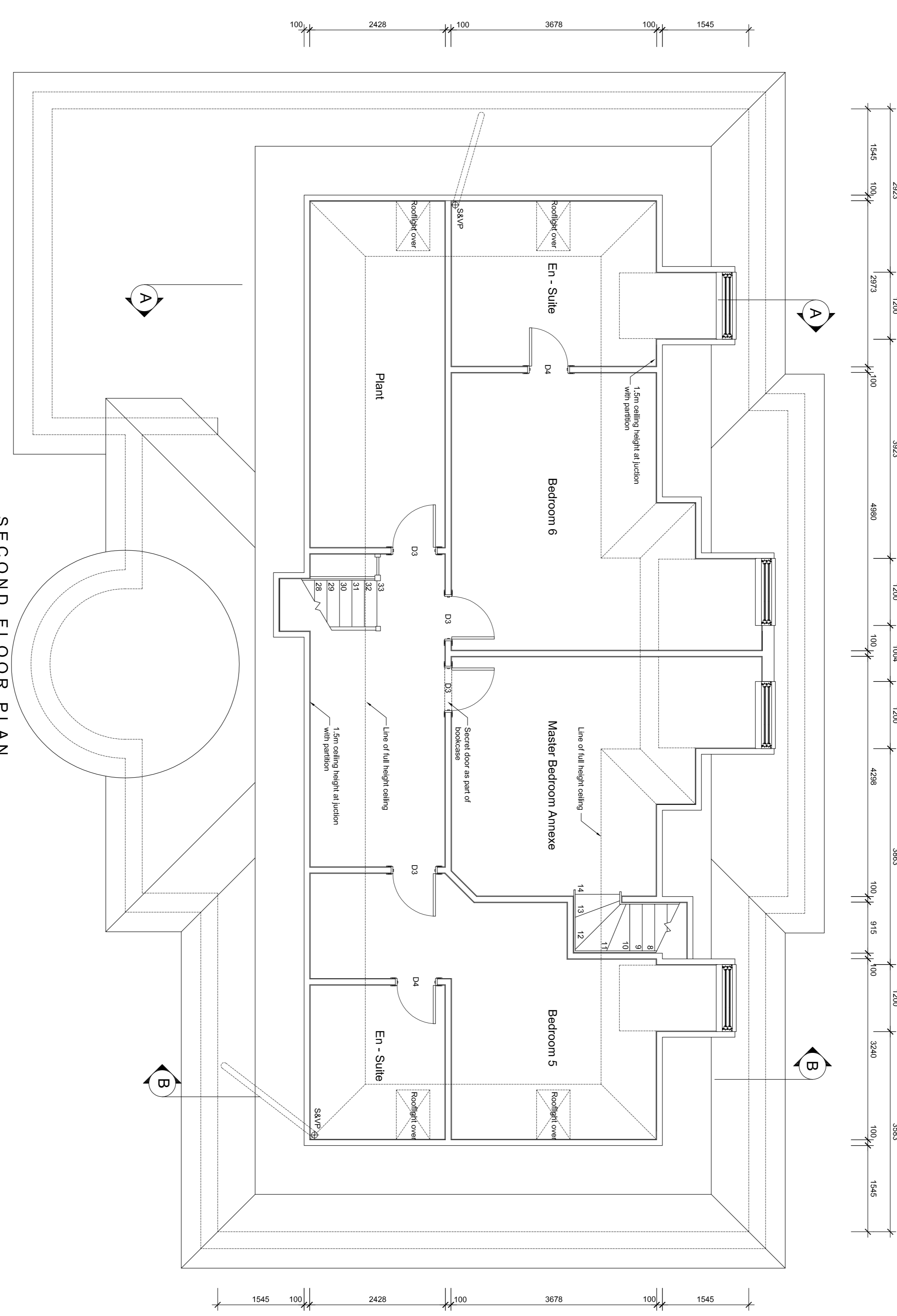

SECOND FLOOR PLAN

C. 06-09-08 additional info added
 B. 28-05-08 section lines added
 A. 01-02-08 similar alterations made following meeting on the 29-04-08.
 Client
Sycamore Developments

Title
Second Floor Plan
 Project
**35 Pelhams Walk
 Esther
 Surrey**

fulcrum design
 Office 7 Tenthorn
 Galsford Road, Bookham
 Surrey TW20 9BA
 Tel 01879 414248
 Fax 01372 498430
 Email info@fulcrumdesign.co.uk
 info@fulcrumdesign.co.uk

Scale: 1:50 @ A1	Date: 03/04/08	Drawn by: DM	Rev
07	14	104	C