

All dimensions to be checked on site prior to the commencement of construction, all dimensions are to structure and any discrepancy should be reported immediately to the architect. This drawing may NOT be reproduced in any part or form without written consent from Fulcrum Design Ltd. Subcontractor MUST ensure that they have the latest issued drawing before they commence work on site.

KEY

- SVP Soil & vent pipes 110mm dia
- RWP Rain water downpipe
- BIG Back inlet gully
- SSA Silt stack fitted with air admittance valve
- DDC Direct drain connection
- MVJ Movement joint
- OTG Outside tap with back inlet gully
- OUT Outside tap
- CCR Proprietary insulated cavity closer to all external reveals
- CBV Cavity barrier
- LBY Lath and plaster
- BUS Boiler fixed with foot cast
- GSP Gas point
- AGV Automatic opening ventilator
- RAO Radiator
- BFT Boiler flue terminal
- HTR Heated towel rail
- OGW Obscure glazed window
- LH Insulated lift hatch

- Mechanical Extraction**
- MEU Mechanical extract fan terminal from utility room min extract rate 30 litres / sec
 - MEC Mechanical extract fan terminal from cloak's min extract rate 15 litres / sec
 - MEB Mechanical extract fan terminal from bathroom min extract rate 15 litres / sec
 - MEE Mechanical extract fan terminal from ensuite min extract rate 15 litres / sec
 - MEH Mechanical extract fan terminal from cooker hood min extract rate 30 litres / sec

- Doors**
- ☐ Door leaf shown thus indicates non fire resistant door
 - ◼ Door leaf shown thus indicates 30/30 fire resistant door
 - ◼ Door leaf shown thus indicates 60/60 fire resistant door and fitted with smoke seals.

- Ref Door sizes**
- D1 864 x 1981mm
 - D2 839 x 1981mm
 - D3 762 x 1981mm
 - D4 666 x 1981mm
 - D5 610 x 1981mm
 - D6 533 x 1981mm
 - D7 457 x 1981mm
 - D8 Pair of 638 x 1981mm
 - D9 Pair of 688 x 1981mm
 - D10 Pair of 610 x 1981mm
 - D11 Pair of 532 x 1981mm
 - D12 Pair of 492 x 1981mm
 - D13 Pair of 492 x 1981mm

- Block / Blockwork Hatching**
- ▨ Facing blockwork
 - ▨ 3.5kN/m Uplightweight concrete blockwork
 - ▨ 2kN/m Lightweight concrete blockwork
 - ▨ 10kN/m Lightweight concrete blockwork

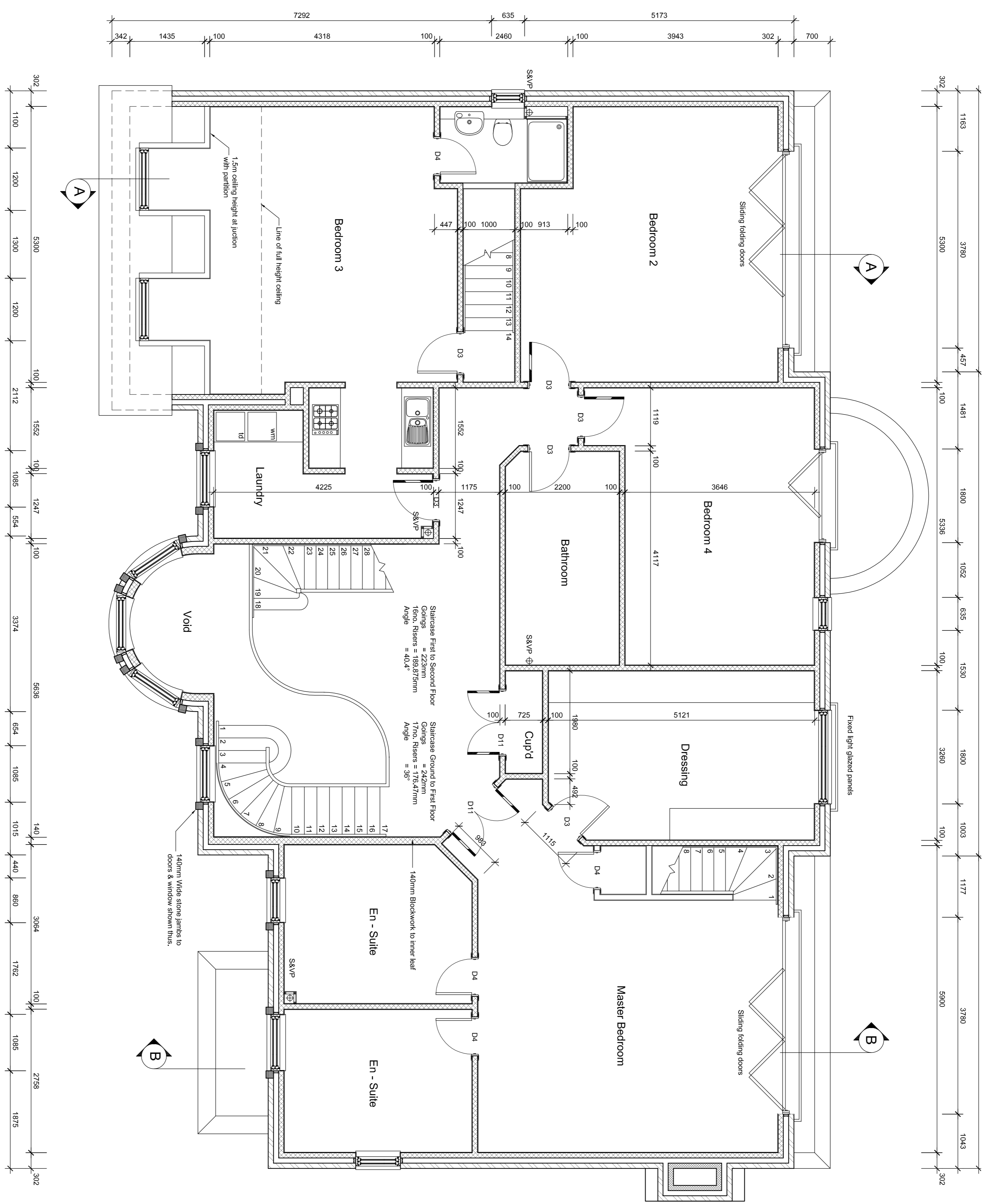

FIRST FLOOR PLAN

Title
First Floor Plan

Project
35 Pelhams Walk
Eshter
Surrey



Scale: 1:50 @ A1	Date: 03/04/08	Drawn by: DW	Rev
07	14	103	E

Site: 7 Terlingham, Guildford Road, Bookham, Surrey GU24 0AB
Tel: 01753 41423, Fax: 01372 499830, Email: info@fulcrumdesign.co.uk, www.fulcrumdesign.co.uk

F: 01-926-68 Window / door stone jambs added.
E: 02-07-08 Sliding folding doors to rear revised.
Q: 11-06-08 Back of landing area revised.
C: 28-05-08 Section lines added.
B: 28-05-08 Section lines added.
A: 01-02-08 Similar alterations made following meeting on the 29/04/08.

Client: Sycamore Developments